

REDUCED TEE 90°

03 Update - 06/2023

TECHNICAL DATA

Article No	001 117 0042 0065
d1 (mm)	63
d2 (mm)	40
L (mm)	216
le1 (mm)	67
le2 (mm)	52
Z (mm)	99
s1 (mm)	5,8
s2 (mm)	3,7
Weight (Kg)	0,280
Box Quantity (pcs)	36
Box Dimension (pcs)	55x30x36

IDENTIFICATION OF PRODUCT

D(mm)	63-40
SDR	11
RAW METARIAL	PE 100
PRESSURE CLASS	16 Bar Water 10 Bar Gas
TRADEMARK	NTG
EXECUTION	Injection Moulded
STANDARD	EN 12201-3 EN 1555-3 AS /NZS 4129

INJECTION MOULDED

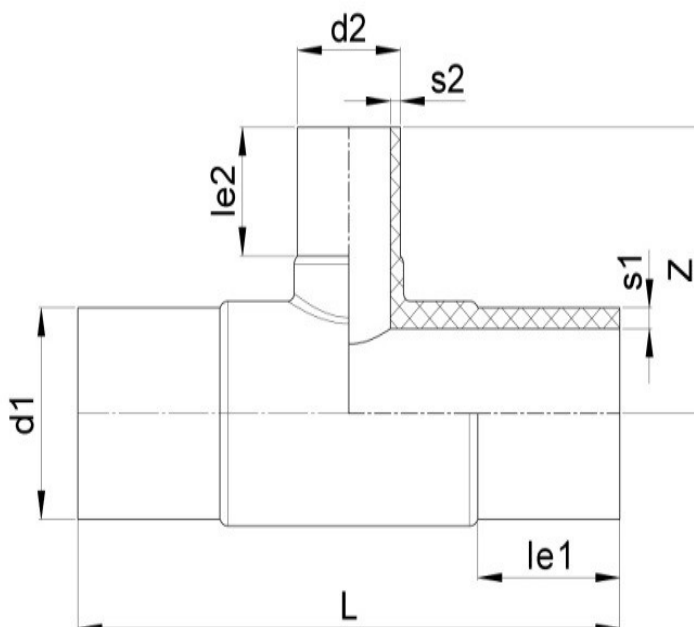

SPECIFICATION

Long Spigot

Tolerance on diameters and thickness according to the standards. The other dimensions are specialized. Tolerance $\pm 5\%$. NTG PLASTIK reserves all the right to change any information without giving prior notice. The production, distribution and utilization of this document without explicit authorization is prohibited.